

## S400-ZD

standard hole pattern

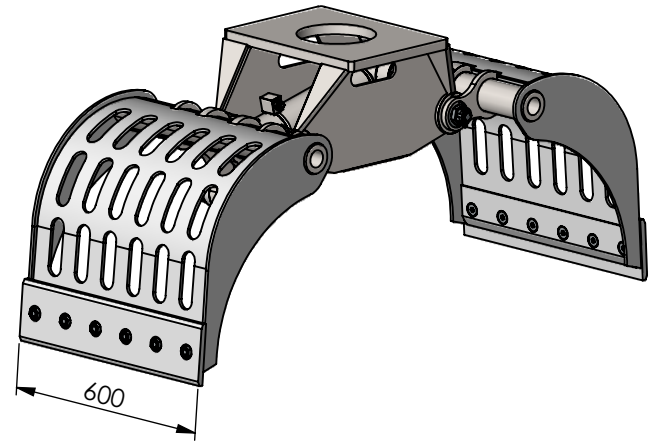

### Type:

Sloop- en sorteergrijper  
Demolition and sorting grab  
Abbruch- und Sortiergreifer  
Grappin de Demolition et de triage

zijkant/side view/  
Seitenansicht/vue de côté

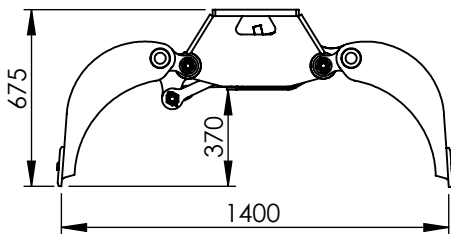

vooraanzicht/front view/  
Vorderansicht/vue de face

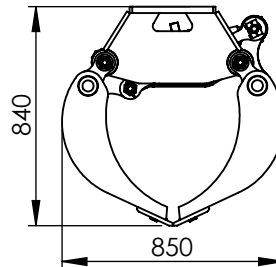

Gatenpatroon/hole pattern/  
Bohrbild/motif de trous

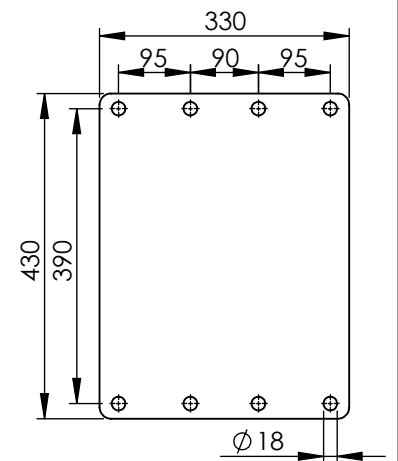

### Technical specifications

| Nederlands  | English  | Deutsch  | Français  |       |      |
|--|---|--|--|-------|------|
| Klasse graafmachine  | Class excavator   | Machine klasse   | Classe de excavatrice  | ton   | 4-6  |
| Gewicht  | Weight  | Gewicht  | Poids  | Kg    | 280  |
| Werkdruk max.  | Op. pressure max  | Betät. druck max   | Pression maximale  | bar   | 300  |
| Olieflow max   | Oil flow max  | Öfluss max   | Débit d'huile max  | l/min | 40   |
| Inhoud   | Content   | Inhalt   | Contenance   | litr. | 150  |
| Sluitkracht  | Closing force   | Schliesskraft  | Force de fermeture   | kN    | 23   |
| Slangaansluiting knijpfunctie  | Hose connect open/close   | Schlauchanschluss kneifen  | Raccord de tuyau fermeture   | -     | \$12 |
| Slangaansluiting draaifunctie  | Hose connect turn function  | Schlauchanschluss drehen   | Raccord de tuyau rotation  | -     | -    |